



STA SUBMERSIBLE DRAINAGE PUMP

50 Hz

ITT Flygt

An **ITT Industries** company

SIA SUBMERSIBLE DRAINAGE PUMP

For domestic, civil and industrial applications like:

- Drainage rain, infiltration and domestic water
- Water pumping from pools, lakes, water-courses and for flood irrigation systems
- Drainage of trenches and marsh grounds

CONSTRUCTION

- 2-pole squirrel cage motor, in a dielectric non-toxic oil bath, enabling ball bearing lubrication with efficient motor cooling. Isolation class F
- Common shaft for pump and motor, suitable for total or partial immersion
- Open impeller with abrasion-resistant coating rubber (NBR)
- Mechanical seal protected by sand labyrinth and lubricated by the motor cooling fluid
- Handle for pump lifting and transport
- Single phase versions are delivered with control box

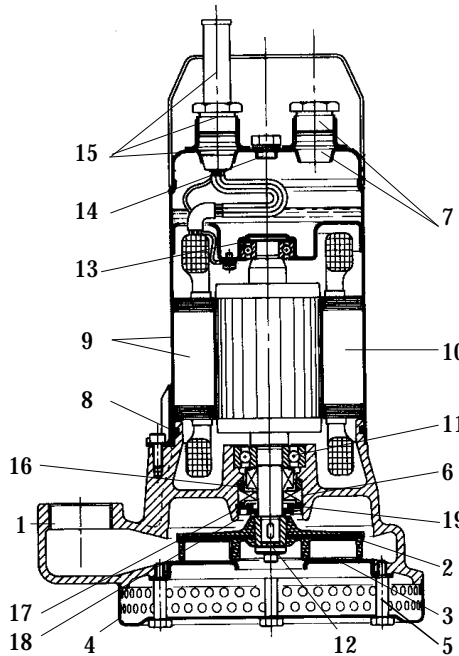

MAIN COMPONENTS

- 1 Pump body, cast iron
- 2 Impeller, rubber coating
- 3 Wear flange
- 4 Suction filter, stainless steel
- 5 Flange filter fixing screw
- 6 Mechanical seal
- 7 Insert & union plug
- 8 O-ring
- 9 Motor housing (stainless steel) with stator
- 10 Shaft & rotor
- 11 Lower bearing
- 12 Impeller lock washer
- 13 Upper bearing
- 14 Plug & washer
- 15 Supply cable gland
- 16 Spacer for mechanical seal
- 17 Shoulder seal washer
- 18 Labyrinth seal cover
- 19 Sand slinger

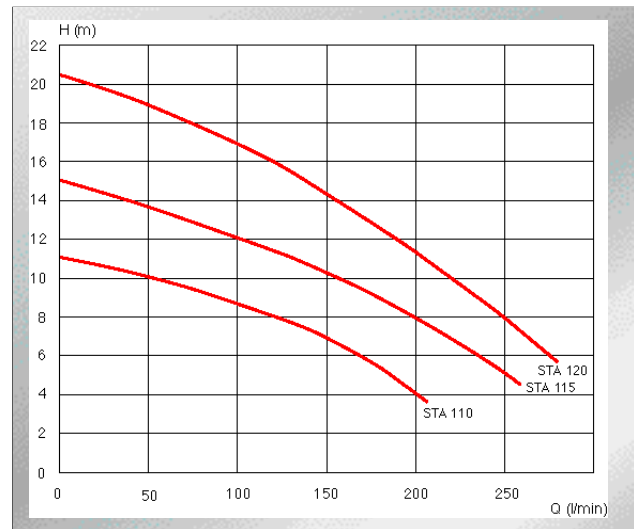
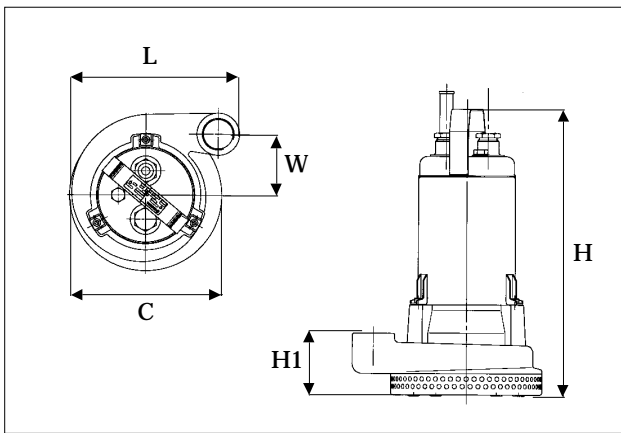

	Pump type		
	STA110	STA115	STA120
Sizes mm C	Ø200	Ø200	Ø200
h	380	380	380
h1	81	81	81
L	209	209	209
L1	223	223	223
W	81	81	81
W1	95	95	95
DNM Discharge connection	G 1 1/4"	G 1 1/4"	G 1 1/4"
Weight kg	18, 5	18, 5	19, 5

	STA110	STA115	STA120
Rated output kW	0.6	0.6	0.75
Max head m	11	15	20.5
Max flow l/min	200	250	275
Rated current			
1-phase A	4	4.7	5.8
3-phase A	1.6	1.8	2.1
Voltage	1-phase 230 V, 3-phase 400 V		
Max temp of pumped liquid	25°C with pump partially submerged 50°C with pump fully submerged		
Cable HO7RN-F	5 m		
Float switch	optional		

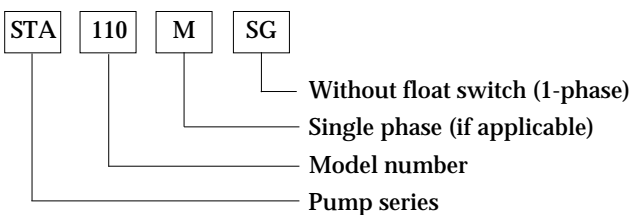

An ITT Industries company

893222